

Multipurpose Clamp Model LC-U (Sideshifting)

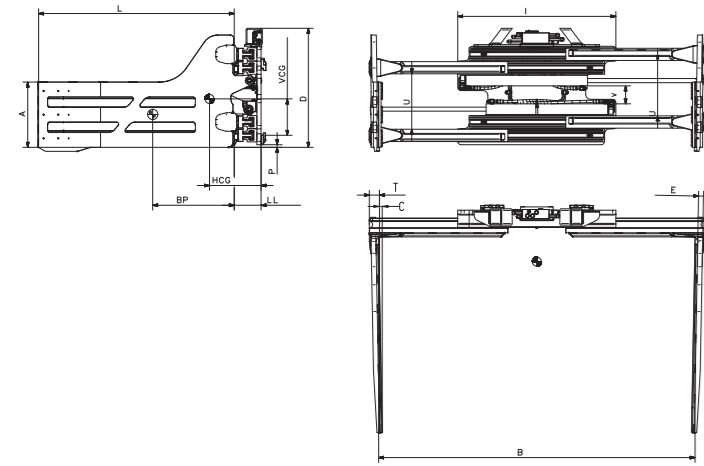

Range: 1,400 - 2,200 kg.

- For the handling of un palletized loads.
- Bolted replaceable rubber stripes.
- Safe gripping of the load with rubber, even at reduced clamping pressures.
- Robust design for heavy-duty applications.
- High tensile aluminium profiles, reversible and interchangeable with wear resistant plastic inserts, allow long life and low lifetime cost.
- Excellent visibility.
- Block valve in the middle for precise arm synchronism.
- The valve and the cylinder rods are protected in every opening position.
- Optimized weight, effective thickness and center of gravity.

Model	Capacity	Load Centre	Frame Width	Opening Range	Arm Dimensions	Weight	Effective Thickness	Horizontal Center of Gravity	Vertical Center of Gravity	Arms Toe-in	Ground Clearance	Mounting Class
	Q Kg	BP mm	I mm	B mm	LxA	W Kg	LL mm	HCG mm	VCG mm	C mm	P mm	
LC 14 U6A 55-178	1400	500	930	560-1790	1200x400	406	142	318	224	37	14	2A
LC 18 U6A 61-194	1800	500	970	610-1940	1200x400	478	164	316	223	32	16	2A
LC 18 U4A 61-194	1800	500	970	610-1940	1000x600	497	164	300	251	18	16	2A
LC 18 U5A 61-194	1800	500	970	610-1940	1050x700	497	164	318	266	19	16	2A
LC 18 U4A 61-194	1800	500	970	610-1940	1000x700	497	164	302	265	18	16	2A
LC 18 U6A 44-173	1800	500	1100	440-1730	1200x400	497	164	311	224	32	16	2A
LC 18 U5A 44-173	1800	500	1100	440-1730	1100x570	497	164	323	245	30	16	2A
LC 22 U6A 44-173	2200	500	1100	440-1730	1200x400	497	164	311	224	32	16	2A
LC 22 U5A 55-182	2200	500	970	550-1820	1130x620	497	164	293	253	21	41	2A
LC 22 U4A 55-182	2200	500	970	550-1820	1000x620	497	164	293	253	18	41	2A
LC 22 U4A 55-182	2200	500	970	550-1820	1000x620	497	163	307	260	18	41	2A
LC 22 U6A 55-182	2200	500	970	550-1820	1200x620	556	163	384	251	22	41	2A
LC 28 U6B 80-250	2800	500	1450	800-2500	1200x500	703	164	289	284	21	16	2A
LC 28 U6B 110-280	2800	500	1830	1100-2800	1200x500	783	164	266	286	20	16	2A

Notes:

- Two hydraulic functions required.
- E= arm thickness at tip with rubber.
- T= arm thickness at base with rubber.
- Check valve with power regeneration hydraulic circuit.
- Pressure relief valve.
- Arms welded to the guides.
- Replaceable rubber facing.

Options:

- Quick-change lower hooks.
- Connection hose kit.
- Special arm on request.

BOLZONI AURAMO (WUXI) FORKLIFT TRUCK ATTACHMENT CO., LTD.
No. 2566 Antai 2nd Road, Xishan District, Wuxi City, Jiangsu Province, P.R. China
Tel: +86 510 88535365 (sales)
Fax: +86 510 8853 5635 sales hotline: 400 690 5305
Email: sales.china@bolzonigroup.com
Website: www.bolzonigroup.com



Pallet Fork Clamp-Model LC-40 (Sideshifting)

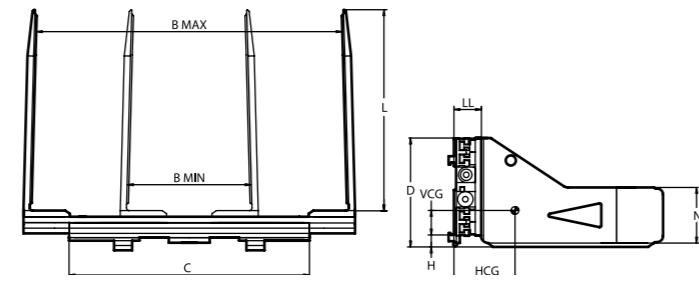

Range: 4,000kg

- Commonly used for handling pulp bales in the paper industry, as well as for bales of cotton, wool, tobacco, fabrics and other baled materials.
- Robust design for heavy-duty applications.
- High tensile aluminium profiles, reversible and interchangeable with wear resistant plastic inserts, allow long life and low lifetime cost.
- Block valve in the middle for precise arm synchronism.
- Excellent visibility.
- The valve and the cylinder rods are protected in every opening position.
- Optimized weight, effective thickness and center of gravity.

Model	Capacity	Load Centre	Opening Range	Arm Length	Arm Height	Frame Width	Height	Weight	Horizontal Center of Gravity	Vertical Center of Gravity	Effective Thickness	Mounting Height	Mounting Class
	Q Kg	BP mm	B mm	L mm	N mm	C mm	D mm	W Kg	HCG mm	VCG mm	LL mm	H mm	ISO 2328
LC40G6B/C	4000	800	610-2190	1200	445	1400	825	1025	279	x	237	74	3/4A
LC40G8B/C	4000	800	610-2170	1400	445	1400	825	1080	321	x	237	74	3/4A
LC40G10B/C	4000	800	610-2160	1600	445	1400	825	1140	394	x	237	74	3/4A
LC40G6B/C	4000	800	710-2390	1200	445	1400	825	1045	276	x	237	74	3/4A
LC40G8B/C	4000	800	710-2370	1400	445	1400	825	1100	317	x	237	74	3/4A
LC40G10B/C	4000	800	710-2360	1600	445	1400	825	1160	390	x	237	74	3/4A
LC40G6B/C	4000	800	610-2390	1200	445	1600	825	1050	273	x	237	74	3/4A
LC40G8B/C	4000	800	610-2370	1400	445	1600	825	1100	314	x	237	74	3/4A
LC40G10B/C	4000	800	610-2360	1600	445	1600	825	1165	387	x	237	74	3/4A
LC40G6B/C	4000	800	710-2590	1200	445	1600	825	1070	270	x	237	74	3/4A
LC40G8B/C	4000	800	710-2570	1400	445	1600	825	1120	311	x	237	74	3/4A
LC40G10B/C	4000	800	710-2560	1600	445	1600	825	1185	382	x	237	74	3/4A
LC40G6B/C	4000	800	610-2590	1200	445	1800	825	1090	264	x	237	74	3/4A
LC40G8B/C	4000	800	610-2570	1400	445	1800	825	1140	304	x	237	74	3/4A
LC40G10B/C	4000	800	610-2560	1600	445	1800	825	1210	374	x	237	74	3/4A
LC40G6B/C	4000	800	710-2790	1200	445	1800	825	1110	261	x	237	74	3/4A
LC40G8B/C	4000	800	710-2770	1400	445	1800	825	1165	301	x	237	74	3/4A
LC40G10B/C	4000	800	710-2760	1600	445	1800	825	1230	370	x	237	74	3/4A

Notes:

- Two hydraulic functions.
- E= arm thickness at tip, without rib.
- T= arm thickness at base, without rib.
- Arms welded directly to the guides.
- Check valve and pressure adjustment valve.
- Integral sideshift.

Options:

- Connection hose kit.
- Cylinder protection
- Valve protection.

BOLZONI AURAMO (WUXI) FORKLIFT TRUCK ATTACHMENT CO., LTD.
No. 2566 Antai 2nd Road, Xishan District, Wuxi City, Jiangsu Province, P.R. China
Tel: +86 510 88535365 (sales)
Fax: +86 510 8853 5635 sales hotline: 400 690 5305
Email: sales.china@bolzonigroup.com
Website: www.bolzonigroup.com



Block Clamp Model LS22/28

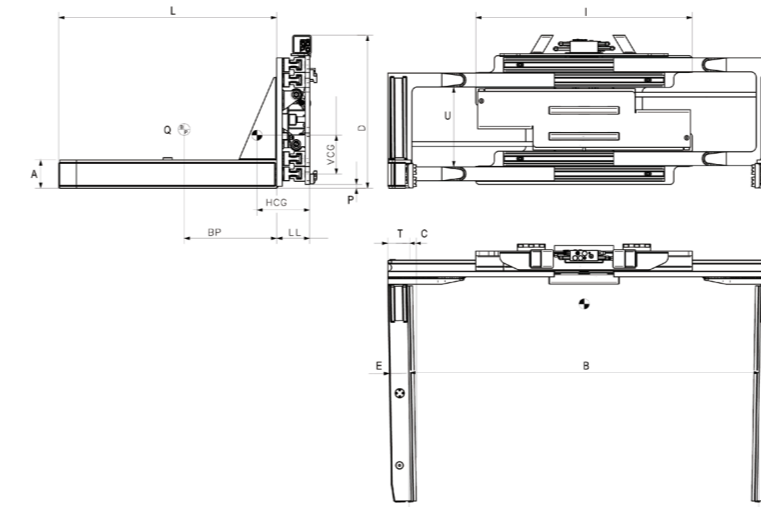

Range: 2,200-2,800kg.

- Double aluminum profile.
- Reduced weight, effective thickness and center of gravity. Excellent visibility.
- Special wear-resistance strip for arm.

Model	Capacity	Load Centre	Frame Width	Opening Range	Arm Dimensions	Weight	Effective Thickness	Horizontal Center of Gravity	Vertical Center of Gravity	Arms Toe-in	Ground Clearance	Mounting Class
	Q Kg	BP mm	I mm	B mm	LxA	W Kg	LL mm	HCG mm	VCG mm	C mm	P mm	
LS 22 A4A 43-189	2200	500	1170	430-1890	1000x150	528	179	237	186	20	21	2A
LS 25 A6B 30-160	2500	500	1100	300-1600	1260x180	665	139	390	172	21.5	21	3A
LS 28 A4B 43-189	2800	500	1170	430-1890	1200x150	571	179	283	212	24	21	3A

Notes:

- One hydraulic function required.
- E=arm thickness at half length.
- T=arm thickness at the base.
- Check valve with power regeneration hydraulic circuit.
- Pressure relief valve.
- Arms welded to the guides.

Options:

- Special opening ranges.
- Separate sideshift.
- Integral sideshift.
- Quick change lower hooks.
- Pressure gauge.
- Load backrest.

BOLZONI AURAMO (WUXI) FORKLIFT TRUCK ATTACHMENT CO., LTD.
No. 2566 Antai 2nd Road, Xishan District, Wuxi City, Jiangsu Province, P.R. China
Tel: +86 510 88535365 (sales)
Fax: +86 510 8853 5635 sales hotline: 400 690 5305
Email: sales.china@bolzonigroup.com
Website: www.bolzonigroup.com



Parallel Clamps Models LC

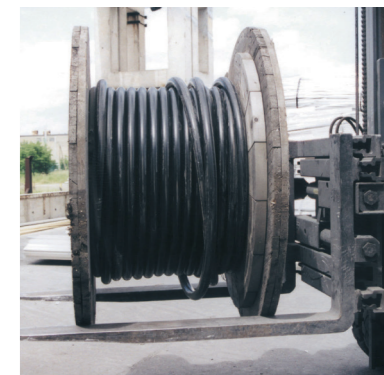
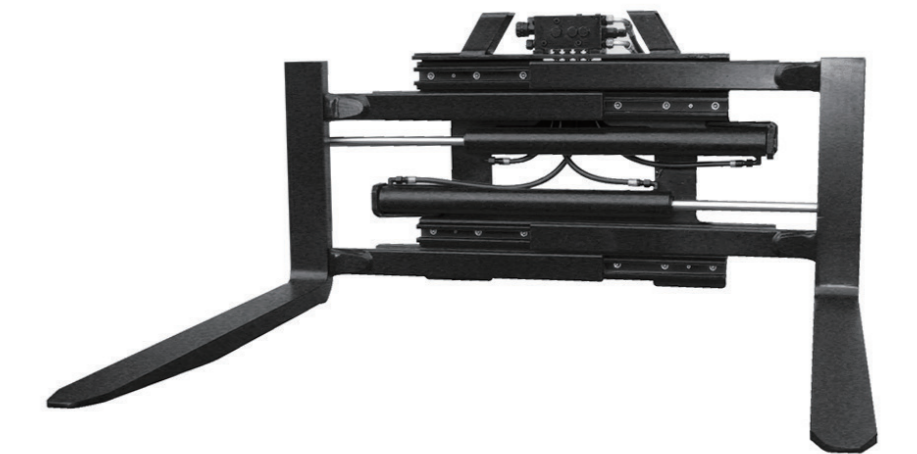

User-friendly, easy to maintain, cost-effective

In today's industries there is a growing demand for handling materials quickly, efficiently and at low cost.

SILVER LINE is a range of reliable and cost-effective clamps suitable for applications in many industries, particularly where lift truck operators require attachments having simple performance and low cost.

The bale clamp and fork clamp ranges include capacities and openings suitable to cover the majority of material handling requirements.



Long life and long service intervals

- Combination of proven and high tensile aluminium channels with new wear resistant plastic inserts.
- No wear on aluminium profiles.
- Symmetrical borings in aluminium channels and symmetrical plastic inserts.
- Higher sliding speed with lower grease requirement.



Simple and quick exchange of wear parts

- Plastic bushings inserted from the side without removing clamp arms.
- Aluminium channels with commercial hexagonal bolts, no special tools required.



Cost-effective: a new clamp at the price of a used one

- High volume production of dedicated range of capacities and openings resulting in manufacturing savings.
- New cost-effective components – such as aluminium profiles, cylinders and wear parts – and optimized manufacturing processes.



Bale Clamp Model LC-G

Commonly used for handling pulp and waste paper bales in the paper industry, as well as for bales of cotton, wool, tobacco, fabrics and other bales materials.

- Robust design for heavy-duty applications. Optimized weight and lost load allow high residual capacity of forklift
- High tensile aluminium profiles, reversible and interchangeable with wear resistant plastic inserts, allow long life and low lifetime cost.
- Adjustable pressure relief for opening/closing for internal hydraulics protection and sideshift function for flexible operation.
- Block valve for precise arm synchronism
- Excellent visibility for safe handling.

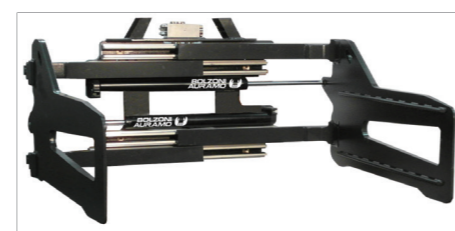

LC-G Model

Pallet Fork Clamp Model LC-H

Versatile attachment, it can be used to lift all conventional pallets, as fork positioner, or to clamp unpalletised loads.

- Robust design for heavy-duty applications. Optimized weight and lost load allow high residual capacity of forklift.
- High tensile aluminium profiles, reversible and interchangeable with wear resistant plastic inserts, allow long life and low lifetime cost.
- Block valve for precise arm synchronism.
- Adjustable pressure relief for opening/closing for internal hydraulics protection and sideshift function for flexible operation.
- Excellent visibility for safe handling.
- Suitable also for applications with extreme long forks.



LC-H Model

Oil flow rate recommendations

Model	Oil Flow Rate, Clamps		
	Minimum L/min	Recommended L/min	Maximum L/min
LC 14	15	25	35
LC 22	15	25	35
LC 25	15	25	35
LC 28	15	25	35
LC 32	30	45	60

Hydraulic functions and hydraulic pressure recommendations

Model	Clamping Pressure		Rotation Pressure		Hydraulic Functions
	Minimum MPa	Maximum MPa	Minimum MPa	Maximum MPa	
LC 14	4	16	-	-	1/2
LC 22	4.5	16	-	-	1/2
LC 25	5	16	-	-	1/2
LC 28	5	16	-	-	1/2
LC 32	5	16	-	-	1/2

Bale Clamp - Model LC-G (Sideshifting)

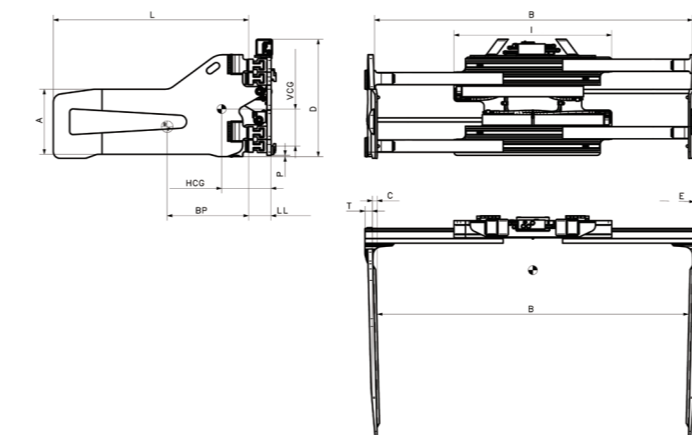

Range: 1,400-3,200kg.

- Commonly used for handling pulp bales in the paper industry, as well as for bales of cotton, wool, tobacco, fabrics and other baled materials.
- Robust design for heavy-duty applications.
- High tensile aluminium profiles, reversible and interchangeable with wear resistant plastic inserts, allow long life and low lifetime cost.
- Block valve in the middle for precise arm synchronism.
- Excellent visibility.
- The valve and the cylinder rods are protected in every opening position.
- Optimized weight, effective thickness and center of gravity.

Model	Capacity	Load Centre	Opening Range	Frame Width	Arm Dimensions	Effective Thickness	Weight	Horizontal Center of Gravity	Vertical Center of Gravity	Arms Toe-in	Mounting Class
	Q Kg	BP mm	B mm	I mm	LxA	LL mm	W Kg	HCG mm	VCG mm	C mm	
LC 14 G4A 58-181	1400	500	580-1810	930	1000x400	117	390	265	232	25	2A
LC 14 G6A 58-181	1400	500	580-1810	930	1200x400	117	418	323	226	30	2A
LC 22 G4A 64-197	2200	500	640-1970	970	1000x400	139	478	251	233	25	2A
LC 22 G6A 64-197	2200	500	640-1970	970	1200x400	139	478	305	227	30	2A
LC 22 G6A 87-220	1400	500	870-2200	970	1200x400	139	480	305	227	30	2A
LC 22 G6A 53-186	2200	500	530-1860	1080	1200x400	139	492	297	229	30	2A
LC 28 G6B 64-237	2800	500	640-2370	1420	1200x400	132	634	295	256	12	3A
LC 28 G6B 64-197	2800	500	640-1970	1020	1200x400	132	560	327	251	12	3A
LC 28 G6B 47-176	2800	500	470-1760	1150	1200x400	132	577	318	252	12	3A
LC 28 G6B 56-250	2800	500	560-2500	1710	1200x500	132	713	309	267	12	3A
LC 32 G6B 59-213	3200	600	590-2130	1280	1200x450	169	830	289	293	21	3A
LC 32 G6B 64-210	3200	600	640-2100	1210	1200x450	169	835	291	293	21	3A
LC 32 G6B 64-237	3200	600	640-2370	1420	1200x450	169	887	278	295	21	3A
LC 32 G8B 64-237	3200	600	640-2370	1420	1500x450	169	1000	364	283	26	3A
LC 32 G4B 50-195	3200	600	500-1950	1280	1000x450	169	790	254	296	21	3A
LC 32 G6B 50-195	3200	600	500-1950	1280	1200x450	169	830	292	293	21	3A

Notes:

- Two hydraulic functions.
- E = arm thickness at tip, without rib.
- T = arm thickness at base, without rib.
- Arms welded directly to the guides.
- Check valve and pressure adjustment valve.
- Integral sideshift.

Options:

- Connection hose kit.
- Cylinder protection
- Valve protection.

Pallet Fork Clamp - Model LC-H (Sideshifting)

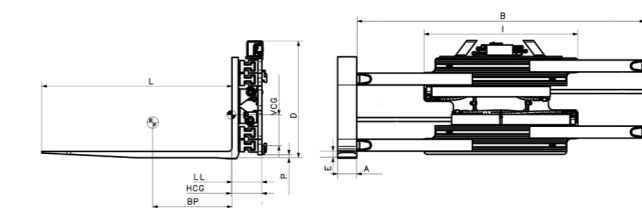

Range: 1,400-2,800kg.

- Versatile attachment, it can be used to lift all conventional pallets, as fork positioner, or to clamp unpalletised loads.
- Robust design for heavy-duty applications.
- High tensile aluminium profiles, reversible and interchangeable with wear resistant plastic inserts, allow long life and low lifetime cost.
- Excellent visibility.
- Block valve in the middle for precise arm synchronism.
- The valve and the cylinder rods are protected in every opening position.
- Optimized weight, effective thickness and center of gravity.

Model	Capacity	Load Centre	Mounting Class	Frame Width	Opening Range in in	Fork Dimensions	Weight	Effective Thickness	Horizontal Center of Gravity	Vertical Center of Gravity	Toe in
	Q1/Q2 Kg	BP mm		I mm	B mm	LxAxE - T mm	W Kg	LL mm	HCG mm	VCG mm	C mm
LC 14 H6A 47-170	1400	500	II	930	470-1700	1200x100x40	310	167	188	195	
LC 14 H6A 35-158	1400	500	II	1050	350-1580	1200x100x40	321	167	181	198	
LC 22 H6A 32-161	2200	500	II	1100	320-1610	1200x120x40	392	189	190	196	
LC 22 H6A 49-182	2200	500	II	970	490-1820	1200x120x40	389	189	193	194	
LC 22 H6A 47-180	2200	500	II	970	470-1800	1200x120x40	400	189	200	192	
LC 28 H6B 32-161	2800	500	III	1100	320-1610	1200x120x45	473	189	185	239	
LC 28 H6B 47-193	2800	500	III	1100	470-1930	1200x130x50	473	199	214	229	
LC 28 H6B 22-158	2800	500	III	1270	220-1580	1200x120x45	443	189	175	244	
LC 28 H6B 32-161	2800	500	III	1100	320-1610	1200x120x45	411	189	186	240	
LC 28 H6B 32-178	2800	500	III	1270	320-1780	1200x120x45	450	189	174	245	
LC 28 H8B 42-208	2800	500	III	1370	420-2080	1650x120x45	511	189	248	228	
LC 28 H6B 42-208	2800	500	III	1370	420-2080	1200x120x45	473	189	168	249	

Notes:

- Two hydraulic functions.
- Q1 = capacity when clamping.
- Q2 = capacity on the forks.
- Check and pressure adjustment valve.
- Pressure gauge.
- Forks welded to the arm carriers.
- Integral sideshift.

Options:

- Connection hose kit.
- Cylinder protection
- Valve protection.



BOLZONI AURAMO (WUXI) FORKLIFT TRUCK ATTACHMENT CO., LTD.
No. 2566 Antai 2nd Road, Xishan District, Wuxi City, Jiangsu Province, P.R. China
Tel: +86 510 88535365 (sales)
Fax: +86 510 8853 5635 sales hotline: 400 690 5305
Email: sales.china@bolzonigroup.com
Website: www.bolzonigroup.com



BOLZONI AURAMO (WUXI) FORKLIFT TRUCK ATTACHMENT CO., LTD.
No. 2566 Antai 2nd Road, Xishan District, Wuxi City, Jiangsu Province, P.R. China
Tel: +86 510 88535365 (sales)
Fax: +86 510 8853 5635 sales hotline: 400 690 5305
Email: sales.china@bolzonigroup.com
Website: www.bolzonigroup.com

